



havuz nozulları, savak ızgaraları
dip süzgeçleri, skimmerler

*pool nozzles, over flow gratings,
main drains, skimmers*



2026
Fiyat Listesi-Price List



NOZBART®
The best of the world...

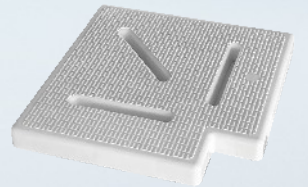
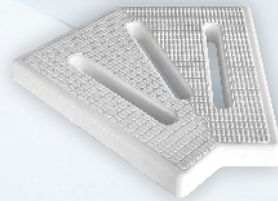
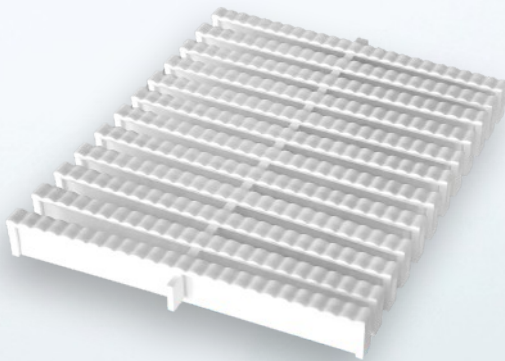

TÜM

**TÜV
CERT**
DIN EN ISO 9001:2015
Zertifikat 15 100 52993

TSE

EAC

CE

UHE
* UHE Kurucu Üyesidir.*

PLASTİK VE MAKİNA KALIP SANAYİ VE TİCARET LİMİTED ŞİRKETİ

- ▶ Besleme nozullarında yeni mükemmel tasarım 80 farklı çeşidiyle en geniş kullanım alanı
New excellent design inlets and wide range of applications with 80 different types
- ▶ Beton, liner, panel ve polyester her türlü havuza uygun nozullar ile geniş ürün yelpazesi.
Wide range of inlets suitable for all kinds of pools: Concrete, liner, panel, polyester
- ▶ Anahtarla sıkma segmanı sıkılarak küre sabitlenir. Piyasadaki diğer modeller gibi yüzücülerin nozul kapağını sökmesiyle küre havuz içine düşmez.
The ball is fixed by tightening squeeze ring with key. Ball doesn't fall into pool (contrarily of other models on the market) when swimmers remove the nozzle cover.

- ▶ Nozul gövdesinin içindeki parçalar birbiriyle uyumludur. İsteğinize göre;
Parts inside the inlet body are compatible with each other. Can be used and changed easily, optionally as;

Çeşitli debilerde küreli yandan besleme nozulu,
Wall inlet with pivoting ball on different flows

Debi ayarlı tabandan besleme nozulu,
Adjustable floor inlet

Yandan çıkışlı besleme nozulu,
Output side inlet

Kafesli (sabit debili) besleme - emiş nozulu
Fixed-flow floor inlet-suction with safety cage

Vakum nozulu olarak zahmetsizce değiştirip kullanılabilir.
Suction inlet



Debi ayarını yapın yıldız tornavida ile vidayı sıkarak sabitleyin!
Adjust the flow rate and tighten the screw with a screwdriver!

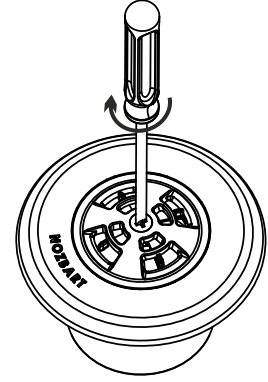

- ▶ Yapıştırılmalı modeller 63 mm U-PVC (PN10) borunun içine yapıştırılabilir.
Solvent models can be glued into a 63 mm U-PVC (PN10) pipe.
- ▶ Dişli modeller 2" boru dişlidir. Bütün modellerin içine 50 mm U-PVC boru yapıştırılabilir.
Threaded models are 2" pipe threaded. 50 mm U-PVC pipe can be glued into all models.
- ▶ Mafsallı modeller yapıştırma tarafındaki tam küre tasarımı ile 10 dereceye kadar tesisat hatalarında sorunsuz montaj sağlar.
Hinged models with complete ball design on solvent side, provide smooth mounting on installations up to 10 degrees errors.
- ▶ Küreli besleme nozulları 2,2 - 4,5 - 7 m³/saat debili olarak özel üretilmiştir. Bu nedenle piyasada mevcut diğer modellerde olduğu gibi küreyi kırmak için ilave işçilik ve aparat gereksinimi bulunmaz. İsteddiğiniz debi değerinde kullanılmaya hazırdır.
Inlets with pivoting ball are produced as flow of 2,2 - 4,5 - 7 m³/hour. Therefore no additional workmanship and apparatus are required to break the ball as in other models available in the market. It is ready to be used at the desired flow rate.

- ▶ Nozullar orjinal ABS malzemeden üretilmiştir. UV ve antioksidant katkıları, uzun ömürlüdür.
Nozzles are produced from original ABS material reinforced with UV and antioxidant.

- ▶ Küreli (Emniyet kafesli) ve tabandan besleme nozullarımız EN 13451-3'e uygundur.
Wall inlet with pivoting ball and floor inlets with safety cage are suitable to EN 13451-3.

- ▶ Parmak sıkışma emniyetli olup delikler 8 mm'den küçüktür.
Finger jam is secure and the holes are smaller than 8 mm.

- ▶ Tabandan besleme nozulları özel tasarımı ile havuz zeminindeki suyu hareketlendirir. Zemin kirini yüzeye çıkartarak taşma kanallarından veya skimmerden geçerek havuzu terk etmesine yardımcı olur. Havuz zemininin temiz kalmasını sağlar.
Floor inlets set in motion water in pool floor with its special design, help floor dirt to go on surface and to leave pool by passing through overflow channels or skimmer; allows pool floor to keep clean.

- ▶ Debi ayarlı nozullar, hassas debi ayarına imkân verir. Bir kez ayarlandığında üstteki civatası sıkılarak sabit hale gelir, konumu değişmez ve mükemmel bir havuz dengesi sağlar.
Adjustable floor inlets allow accurate flow adjustment. Once set, it is fixed by tightening top bolts. Its position doesn't change and provides excellent pool stability.





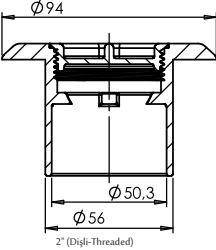
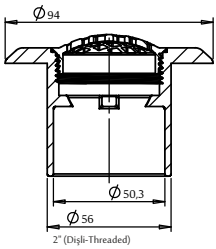
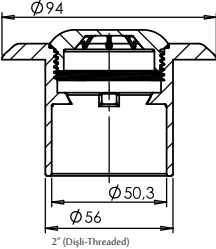
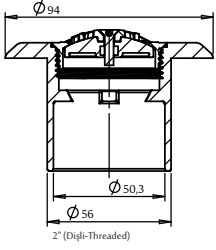
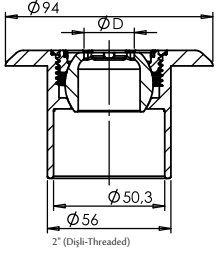

BETON Havuzlar / CONCRETE Pools

Model	Debi m ³ /saat	63mm UPVC PN10 Yapıştırma / Solvent	Mafsallı / Hinged (63mm PN10)	2" Dişli / Threaded	
		İç - Inside 50mm Yapıştırma / Solvent	Yapıştırma / Solvent	İç - Inside 50mm Yapıştırma / Solvent	
		Kod / Code	Kod / Code	Kod / Code	
Kürelü Yandan Besleme Nozulu <i>Wall Inlet with Pivoting Ball</i>	Ø17,5 mm Emniyet kafesli Safety cage	2,2	NOZ-101 3,01 €	NOZ-201 3,35 €	NOZ-301 3,35 €
	Ø22,8 mm Emniyet kafesli Safety cage	4,5	NOZ-102 3,01 €	NOZ-202 3,35 €	NOZ-302 3,35 €
	Ø27,0 mm Emniyet kafesli Safety cage	7	NOZ-103 3,01 €	NOZ-203 3,35 €	NOZ-303 3,35 €
	Ø20 mm Kafesiz Full Bore	4,5	NOZ-104 3,01 €	NOZ-204 3,35 €	NOZ-304 3,35 €
Debi Ayarlı Tabandan Besleme Nozulu <i>Adjustable Floor Inlet</i>		0-4,5	NOZ-105 3,75 €	NOZ-205 4,09 €	NOZ-305 4,09 €
			NOZ-105D 3,75 €	NOZ-205D 4,09 €	NOZ-305D 4,09 €
Yandan Çıkışlı Tabandan Besleme Nozulu <i>Output Side Floor Inlet</i>		4,5	NOZ-106 3,01 €	NOZ-206 3,35 €	NOZ-306 3,35 €
Kafesli Besleme ve Emme Nozulu <i>Floor Inlet and Suction with Safety Cage</i>			NOZ-107 3,01 €	NOZ-207 3,35 €	NOZ-307 3,35 €
	Besleme - Inlet (10 m³/saat) Emiş - Suction (1,25 m³/saat)		NOZ-107D 3,01 €	NOZ-207D 3,35 €	NOZ-307D 3,35 €
Vakum Nozulu <i>Suction Inlet</i>		7	NOZ-108 3,01 €	NOZ-208 3,35 €	NOZ-308 3,35 €



Nozullar orjinal ABS malzemeden üretilmiştir. UV ve antioksidant katkılı, uzun ömürlüdür.
Nozzles are produced from original ABS material reinforced with UV and antioxidant.
Kürelü (Emniyet kafesli) ve tabandan besleme nozullarımız EN 13451-3'e uygundur.
Wall inlet with pivoting ball and floor inlets with safety cage are suitable to EN 13451-3.
Parmak sıkışma emniyetli olup delikler 8 mm'den küçüktür.
Finger jam is secure and the holes are smaller than 8 mm.
Yapıştırma ürünler 10 Bar 63 mm U-PVC borunun içine yapıştırmaya uygundur.
To be glued into a 63 mm PN-10 pipe.

LİNER Havuzlar / LINER Pools

Model		Debi m ³ /saat	63mm U-PVC Pn10 Yapıştırma / Solvent	Mafsallı / Hinged 63mm Pn10	2" Dişli / Threaded
			İç - Inside 50 mm Yapıştırma / Solvent	Yapıştırma / Solvent	İç - Inside 50mm Yapıştırma / Solvent
Sarı vida yuvalı with brass insert			Kod / Code	Kod / Code	Kod / Code
	Ø17,5 mm Emniyet kafesli Safety cage	2,2	NOZ-401 17,04 €	NOZ-501 17,04 €	NOZ-601 17,04 €
	Ø22,8 mm Emniyet kafesli Safety cage	4,5	NOZ-402 17,04 €	NOZ-502 17,04 €	NOZ-602 17,04 €
	Ø27,0 mm Emniyet kafesli Safety cage	7	NOZ-403 17,04 €	NOZ-503 17,04 €	NOZ-603 17,04 €
	Ø20 mm Kafesiz Full Bore	4,5	NOZ-404 17,04 €	NOZ-504 17,04 €	NOZ-604 17,04 €
	Debi Ayarlı Tabandan Besleme Nozulu Adjustable Floor Inlet	0-4,5	NOZ-405 17,89 €	NOZ-505 17,89 €	NOZ-605 17,89 €
			NOZ-405D 17,89 €	NOZ-505D 17,89 €	NOZ-605D 17,89 €
	Yandan Çıkışlı Tabandan Besleme Nozulu Output Side Floor Inlet	4,5	NOZ-406 17,04 €	NOZ-506 17,04 €	NOZ-606 17,04 €
	Kafesli Besleme ve Emme Nozulu Floor Inlet and Suction with Safety Cage		NOZ-407 17,04 €	NOZ-507 17,04 €	NOZ-607 17,04 €
	Besleme - Inlet (10 m ³ /saat) Emiş - Suction (1,25 m ³ /saat)		NOZ-407D 17,04 €	NOZ-507D 17,04 €	NOZ-607D 17,04 €
	Vakum Nozulu Suction Inlet	7	NOZ-408 17,04 €	NOZ-508 17,04 €	NOZ-608 17,04 €

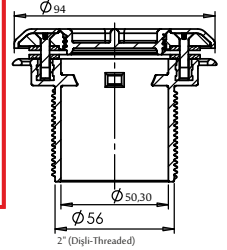
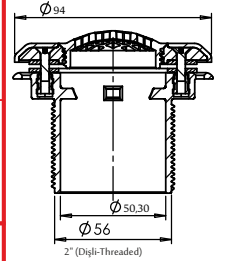
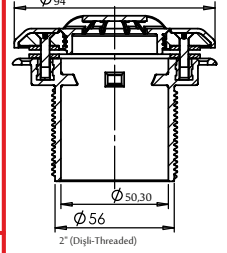
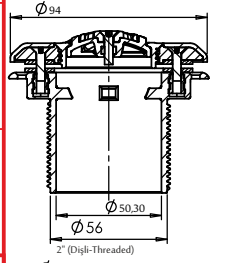
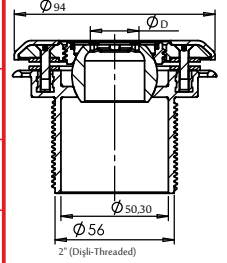

Nozullar orjinal ABS malzemeden üretilmiştir. UV ve antioksidant katkı, uzun ömürlüdür.
Nozzles are produced from original ABS material reinforced with UV and antioxidant.
Kürel (Emniyet kafesli) ve tabandan besleme nozullarımız EN 13451-3'e uygundur.
Wall inlet with pivoting ball and floor inlets with safety cage are suitable to EN 13451-3.
Parmak sıkışma emniyetli olup delikler 8 mm'den küçüktür.
Finger jam is secure and the holes are smaller than 8 mm.
Yapıştırma ürünler 10 Bar 63 mm U-PVC borunun içine yapıştırmaya uygundur.
To be glued into a 63 mm PN-10 pipe.

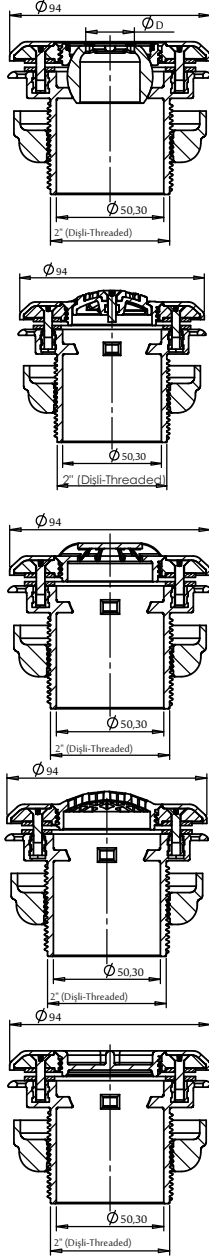

PANEL Havuzlar / PANEL Pools				
Model	Debi m ³ /saat	2" Dişli / Threaded		Fiyat Price €
		İç - Inside 50mm Yapıştırma / Solvent		
		Kod / Code		
Kürel Yandan Besleme Nozulu <i>Wall Inlet Nozzle Pivoting Ball</i>	Ø17,5 mm Küre Emniyet kafesli <i>Safety cage</i>	2,2	NOZ-701	22,01 €
	Ø22,8 mm Küre Emniyet kafesli <i>Safety cage</i>	4,5	NOZ-702	22,01 €
	Ø27,0 mm Küre Emniyet kafesli <i>Safety cage</i>	7	NOZ-703	22,01 €
	Ø20 mm Kafesiz <i>Full Bore</i>	4,5	NOZ-704	22,01 €
Debi Ayarlı Tabandan Besleme Nozulu <i>Adjustable Floor Inlet</i>		0-4,5	NOZ-705	22,86 €
			NOZ-705D	22,86 €
Yandan Çıkışlı Tabandan Besleme Nozulu <i>Floor Inlet Side Output</i>	4,5	NOZ-706	22,01 €	
Kafesli Besleme ve Emme Nozulu <i>Floor Inlet and Suction with Safety Cage</i>	Besleme - Inlet (10 m ³ /saat) Emiş - Suction (1,25 m ³ /saat)		NOZ-707	22,01 €
			NOZ-707D	22,01 €
Vakum Nozulu <i>Suction Inlet</i>	7	NOZ-708	22,01 €	



Nozullar orjinal ABS malzemeden üretilmiştir.
Nozzles were produced from original ABS material.
Kürel (Emniyet kafesli) ve tabandan besleme nozullarımız EN 13451-3'e uygundur.
It is suitable for EN 13451-3 with globe (safety cage) and bottom nozzle.
Parmak sıkışma emniyetli olup delikler 8 mm'den küçüktür.
Finger jam is secure and the holes are 8 mm smaller.

POLYESTER Havuzlar / <i>POLYESTER Pools</i>				
Model	Debi m ³ /saat	2" Dişli / Threaded		Fiyat Price €
		İç - Inside 50 mm Yapıştırma / Solvent	Kod / Code	
Sarı vida yuvalı with brass insert				
Kürelü Yandan Besleme Nozulu <i>Wall Inlet Nozzle Pivoting Ball</i>	Ø17,5 mm Küre Emniyet kafesli <i>Safety cage</i>	2,2	NOZ-801	10,93 €
	Ø22,8 mm Küre Emniyet kafesli <i>Safety cage</i>	4,5	NOZ-802	10,93 €
	Ø27,0 mm Küre Emniyet kafesli <i>Safety cage</i>	7	NOZ-803	10,93 €
	Ø20 mm Kafessiz <i>Full Bore</i>	4,5	NOZ-804	10,93 €
Debi Ayarlı Tabandan Besleme Nozulu <i>Adjustable Floor Inlet</i>		0-4,5	NOZ-805	11,79 €
			NOZ-805D	11,79 €
Yandan Çıkışlı Tabandan Besleme Nozulu <i>Floor Inlet Side Output</i>		4,5	NOZ-806	10,93 €
Kafesli Besleme ve Emme Nozulu <i>Floor Inlet and Suction with Safety Cage</i>			NOZ-807	10,93 €
			NOZ-807D	10,93 €
Besleme - Inlet (10 m³/saat) Emiş - Suction (1,25 m³/saat)				
Vakum Nozulu <i>Suction Inlet</i>		7	NOZ-808	10,93 €

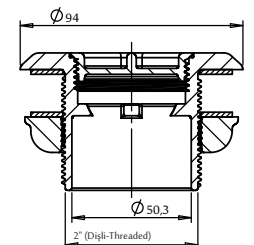
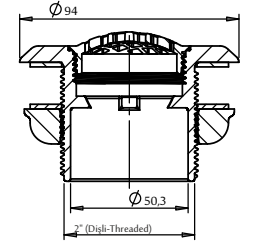
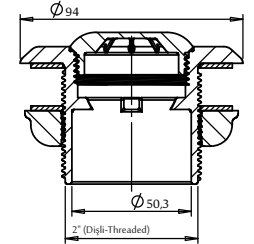
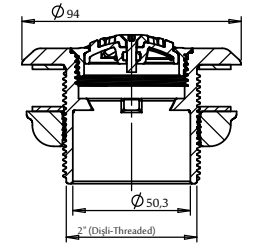
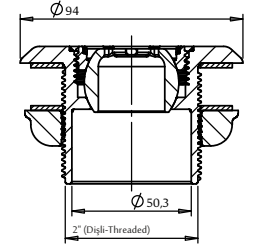

Nozullar orjinal ABS malzemeden üretilmiştir.

Nozzles were produced from original ABS material.

Kürelü (Emniyet kafesli) ve tabandan besleme nozullarımız EN 13451-3'e uygundur.

It is suitable for EN 13451-3 with globe (safety cage) and bottom nozzle.

Parmak sıkışma emniyetli olup delikler 8 mm'den küçüktür.

Finger jam is secure and the holes are 8 mm smaller.

BETON Havuzlar / CONCRETE Pools

Model	Debi m ³ /saat	63mm UPVC PN10 Yapıştırma / Solvent	Mafsallı / Hinged 63mm Pn10	2" Dişli / Threaded	
		İç - Inside 50mm Yapıştırma / Solvent	Yapıştırma / Solvent	İç - Inside 50mm Yapıştırma / Solvent	
		Kod / Code	Kod / Code	Kod / Code	
Kürelü Yandan Besleme Nozulu <i>Wall Inlet with Pivoting Ball</i>	Ø17,5 mm Emniyet kafesli Safety cage	2,2	NOZ-101A 3,01 €	NOZ-201A 3,35 €	NOZ-301A 3,35 €
	Ø22,8 mm Emniyet kafesli Safety cage	4,5	NOZ-102A 3,01 €	NOZ-202A 3,35 €	NOZ-302A 3,35 €
	Ø27,0 mm Emniyet kafesli Safety cage	7	NOZ-103A 3,01 €	NOZ-203A 3,35 €	NOZ-303A 3,35 €
	Ø20 mm Kafesiz Full Bore	4,5	NOZ-104A 3,01 €	NOZ-204A 3,35 €	NOZ-304A 3,35 €
Debi Ayarlı Tabandan Besleme Nozulu <i>Adjustable Floor Inlet</i>		0-4,5	NOZ-105A 3,75 €	NOZ-205A 4,09 €	NOZ-305A 4,09 €
			NOZ-105DA 3,75 €	NOZ-205DA 4,09 €	NOZ-305DA 4,09 €
Yandan Çıkışlı Tabandan Besleme Nozulu <i>Output Side Floor Inlet</i>		4,5	NOZ-106A 3,01 €	NOZ-206A 3,35 €	NOZ-306A 3,35 €
Kafesli Besleme ve Emme Nozulu <i>Floor Inlet and Suction with Safety Cage</i>			NOZ-107A 3,01 €	NOZ-207A 3,35 €	NOZ-307A 3,35 €
	Besleme - Inlet (10 m³/saat) Emiş - Suction (1,25 m³/saat)		NOZ-107DA 3,01 €	NOZ-207DA 3,35 €	NOZ-307DA 3,35 €
Vakum Nozulu <i>Suction Inlet</i>		7	NOZ-108A 3,01 €	NOZ-208A 3,35 €	NOZ-308A 3,35 €

ANTRASİT ANTHRACITE

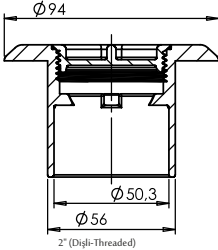
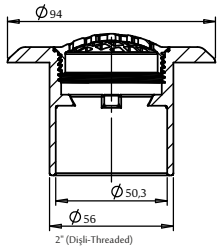
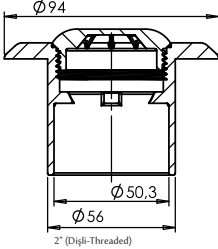
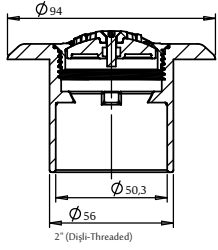
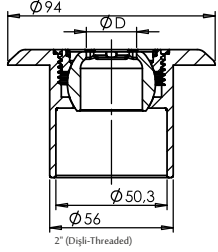

Nozullar orjinal ABS malzemeden üretilmiştir. UV ve antioksidant katkı, uzun ömürlüdür.
 Nozzles are produced from original ABS material reinforced with UV and antioxidant.
 Kürelü (Emniyet kafesli) ve tabandan besleme nozullarımız EN 13451-3'e uygundur.
 Wall inlet with pivoting ball and floor inlets with safety cage are suitable to EN 13451-3.
 Parmak sıkışma emniyetli olup delikler 8 mm'den küçüktür.
 Finger jam is secure and the holes are smaller than 8 mm.
 Yapıştırma ürünler 10 Bar 63 mm U-PVC borunun içine yapıştırmaya uygundur.
 To be glued into a 63 mm PN-10 pipe.

LİNER Havuzlar / LINER Pools

ANTRASİT
ANTHRACITE

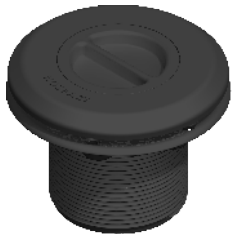
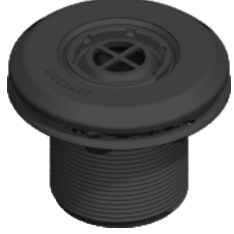

Model		Debi m ³ /saat	63mm UPVC PN10 Yapıştırma / Solvent	Mafsallı / Hinged 63 mm Pn10	2" Dişli / Threaded
Sarı vida yuvalı with brass insert			İç - Inside 50mm Yapıştırma / Solvent	Yapıştırma / Solvent	İç - Inside 50mm Yapıştırma / Solvent
			Kod / Code	Kod / Code	Kod / Code
Kürel Yandan Besleme Nozulu <i>Wall Inlet with Pivoting Ball</i>	Ø17,5 mm Emniyet kafesli Safety cage	2,2	NOZ-401A 17,04 €	NOZ-501A 17,04 €	NOZ-601A 17,04 €
	Ø22,8 mm Emniyet kafesli Safety cage	4,5	NOZ-402A 17,04 €	NOZ-502A 17,04 €	NOZ-602A 17,04 €
	Ø27,0 mm Emniyet kafesli Safety cage	7	NOZ-403A 17,04 €	NOZ-503A 17,04 €	NOZ-603A 17,04 €
	Ø20 mm Kafesiz Full Bore	4,5	NOZ-404A 17,04 €	NOZ-504A 17,04 €	NOZ-604A 17,04 €
Debi Ayarlı Tabandan Besleme Nozulu <i>Adjustable Floor Inlet</i>		0-4,5	NOZ-405A 17,89 €	NOZ-505A 17,89 €	NOZ-605A 17,89 €
			NOZ-405DA 17,89 €	NOZ-505DA 17,89 €	NOZ-605DA 17,89 €
Yandan Çıkışlı Tabandan Besleme Nozulu <i>Output Side Floor Inlet</i>		4,5	NOZ-406A 17,04 €	NOZ-506A 17,04 €	NOZ-606A 17,04 €
Kafesli Besleme ve Emme Nozulu <i>Floor Inlet and Suction with Safety Cage</i>			NOZ-407A 17,04 €	NOZ-507A 17,04 €	NOZ-607A 17,04 €
Besleme - Inlet (10 m³/saat) Emiş - Suction (1,25 m³/saat)			NOZ-407DA 17,04 €	NOZ-507DA 17,04 €	NOZ-607DA 17,04 €
Vakum Nozulu <i>Suction Inlet</i>		7	NOZ-408A 17,04 €	NOZ-508A 17,04 €	NOZ-608A 17,04 €

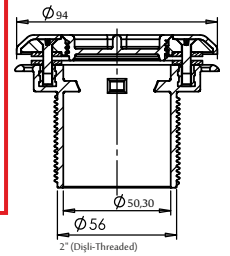
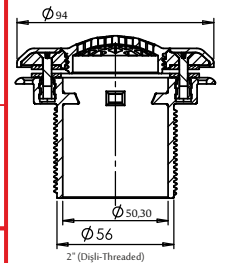
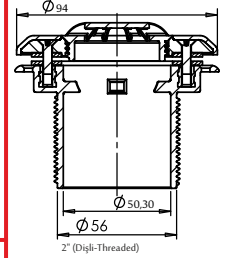
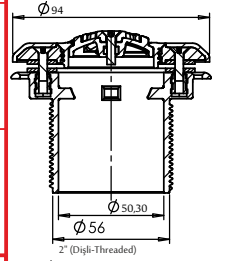
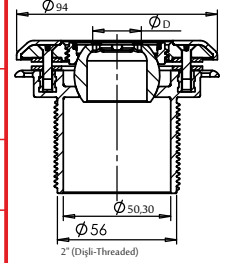

Nozullar orjinal ABS malzemeden üretilmiştir. UV ve antioksidant katkılı, uzun ömürlüdür.
Nozzles are produced from original ABS material reinforced with UV and antioxidant.
Kürel (Emniyet kafesli) ve tabandan besleme nozullarımız EN 13451-3'e uygundur.
Wall inlet with pivoting ball and floor inlets with safety cage are suitable to EN 13451-3.
Parmak sıkışma emniyetli olup delikler 8 mm'den küçüktür.
Finger jam is secure and the holes are smaller than 8 mm.
Yapıştırma türünler 10 Bar 63 mm U-PVC borunun içine yapıştırmaya uygundur.
To be glued into a 63 mm PN-10 pipe.

PANEL Havuzlar / PANEL Pools

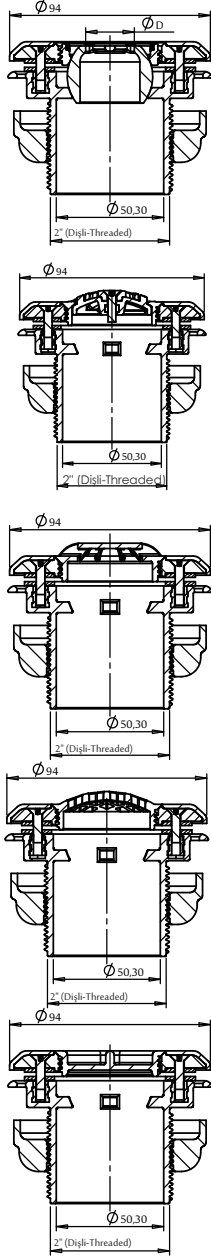

Model	Debi m ³ /saat	2" Dişli / Threaded		Fiyat Price €
		İç - Inside 50mm Yapıştırma / Solvent	Kod / Code	
Kürel Yandan Besleme Nozulu <i>Wall Inlet Nozzle Pivoting Ball</i>	Ø17,5 mm Küre Emniyet kafesli <i>Safety cage</i>	2,2	NOZ-701A	22,01 €
	Ø22,8 mm Küre Emniyet kafesli <i>Safety cage</i>	4,5	NOZ-702A	22,01 €
	Ø27,0 mm Küre Emniyet kafesli <i>Safety cage</i>	7	NOZ-703A	22,01 €
	Ø20 mm Kafesiz <i>Full Bore</i>	4,5	NOZ-704A	22,01 €
Debi Ayarlı Tabandan Besleme Nozulu <i>Adjustable Floor Inlet</i>		0-4,5	NOZ-705A	22,86 €
			NOZ-705DA	22,86 €
Yandan Çıkışlı Tabandan Besleme Nozulu <i>Floor Inlet Side Output</i>	4,5	NOZ-706A	22,01 €	
Kafesli Besleme ve Emme Nozulu <i>Floor Inlet and Suction with Safety Cage</i>			NOZ-707A	22,01 €
	Besleme - Inlet (10 m³/saat) Emiş - Suction (1,25 m³/saat)		NOZ-707DA	22,01 €
Vakum Nozulu <i>Suction Inlet</i>	7	NOZ-708A	22,01 €	

ANTRASİT ANTHRACITE



Nozullar orjinal ABS malzemeden üretilmiştir.

Nozzles were produced from original ABS material.

Kürel (Emniyet kafesli) ve tabandan besleme nozullarımız EN 13451-3'e uygundur.

It is suitable for EN 13451-3 with globe (safety cage) and bottom nozzle.

Parmak sıkışma emniyetli olup delikler 8 mm'den küçüktür.

Finger jam is secure and the holes are 8 mm smaller.

**ANTRASİT
ANTHRACITE**



POLYESTER Havuzlar / <i>POLYESTER Pools</i>				
Model	Debi m ³ /saat	2" Dişli / Threaded		Fiyat Price €
		İç - Inside 50mm Yapıştırma / Solvent	Kod / Code	
Kürel Yandan Besleme Nozulu <i>Wall Inlet Nozzle Pivoting Ball</i>	Ø17,5 mm Küre Emniyet kafesli <i>Safety cage</i>	2,2	NOZ-801A	10,93 €
	Ø22,8 mm Küre Emniyet kafesli <i>Safety cage</i>	4,5	NOZ-802A	10,93 €
	Ø27,0 mm Küre Emniyet kafesli <i>Safety cage</i>	7	NOZ-803A	10,93 €
	Ø20 mm Kafesiz <i>Full Bore</i>	4,5	NOZ-804A	10,93 €
Debi Ayarlı Tabandan Besleme Nozulu <i>Adjustable Floor Inlet</i>		0-4,5	NOZ-805A	11,79 €
			NOZ-805DA	11,79 €
Yandan Çıkışlı Tabandan Besleme Nozulu <i>Floor Inlet Side Output</i>		4,5	NOZ-806A	10,93 €
Kafesli Besleme ve Emme Nozulu <i>Floor Inlet and Suction with Safety Cage</i>			NOZ-807A	10,93 €
	Besleme - Inlet (10 m³/saat) Emiş - Suction (1,25 m³/saat)		NOZ-807DA	10,93 €
Vakum Nozulu <i>Suction Inlet</i>		7	NOZ-808A	10,93 €

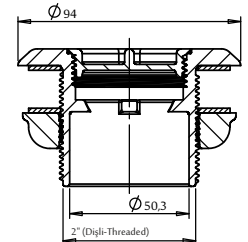
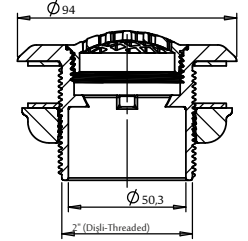
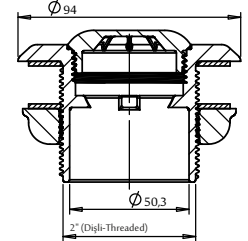
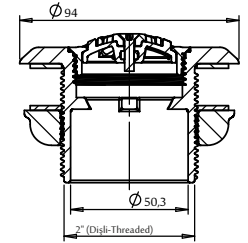
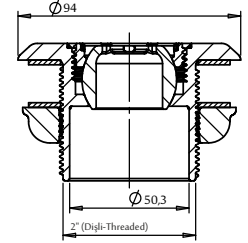

Nozullar orjinal ABS malzemeden üretilmiştir.

Nozzles were produced from original ABS material.

Kürel (Emniyet kafesli) ve tabandan besleme nozullarımız EN 13451-3'e uygundur.

It is suitable for EN 13451-3 with globe (safety cage) and bottom nozzle.

Parmak sıkışma emniyetli olup delikler 8 mm'den küçüktür.

Finger jam is secure and the holes are 8 mm smaller.

BETON Havuzlar / CONCRETE Pools

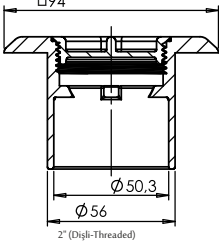
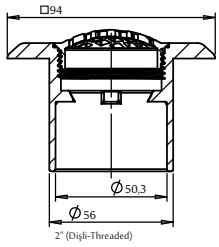
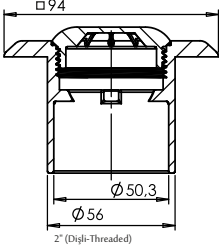
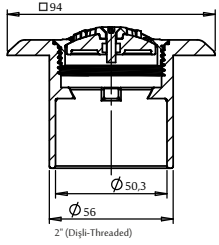
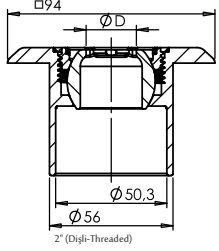

Model		Debi m³/saat	63mm UPVC PN10 Yapıştırma / Solvent	Mafsallı / Hinged 63mm PN10	2" Dişli / Threaded
			İç - Inside 50mm Yapıştırma / Solvent	Yapıştırma / Solvent	İç - Inside 50mm Yapıştırma / Solvent
			Kod / Code	Kod / Code	Kod / Code
Kürelü Yandan Besleme Nozulu <i>Wall Inlet with Pivoting Ball</i>	Ø17,5 mm Emniyet kafesli <i>Safety cage</i>	2,2	NOZK-101 3,01 €	NOZK-201 3,35 €	NOZK-301 3,35 €
	Ø22,8 mm Emniyet kafesli <i>Safety cage</i>	4,5	NOZK-102 3,01 €	NOZK-202 3,35 €	NOZK-302 3,35 €
	Ø27,0 mm Emniyet kafesli <i>Safety cage</i>	7	NOZK-103 3,01 €	NOZK-203 3,35 €	NOZK-303 3,35 €
	Ø20 mm Kafessiz <i>Full Bore</i>	4,5	NOZK-104 3,01 €	NOZK-204 3,35 €	NOZK-304 3,35 €
Debi Ayarlı Tabandan Besleme Nozulu <i>Adjustable Floor Inlet</i>		0-4,5	NOZK-105 3,75 €	NOZK-205 4,09 €	NOZK-305 4,09 €
			NOZK-105D 3,75 €	NOZK-205D 4,09 €	NOZK-305D 4,09 €
Yandan Çıkış Tabandan Besleme Nozulu <i>Output Side Floor Inlet</i>		4,5	NOZK-106 3,01 €	NOZK-206 3,35 €	NOZK-306 3,35 €
Kafesli Besleme ve Emme Nozulu <i>Floor Inlet and Suction with Safety Cage</i>			NOZK-107 3,01 €	NOZK-207 3,35 €	NOZK-307 3,35 €
	Besleme - Inlet (10 m³/saat) Emiş - Suction (1,25 m³/saat)		NOZK-107D 3,01 €	NOZK-207D 3,35 €	NOZK-307D 3,35 €
Vakum Nozulu <i>Suction Inlet</i>		7	NOZK-108 3,01 €	NOZK-208 3,35 €	NOZK-308 3,35 €

KARE SQUARE

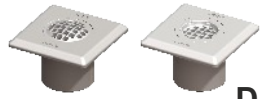

Nozullar orjinal ABS malzemeden üretilmiştir. UV ve antioksidant katkı, uzun ömürlüdür.
Nozzles are produced from original ABS material reinforced with UV and antioxidant.
Kürelü (Emniyet kafesli) ve tabandan besleme nozullarımız EN 13451-3'e uygundur.
Wall inlet with pivoting ball and floor inlets with safety cage are suitable to EN 13451-3.
Parmak sıkışma emniyetli olup delikler 8 mm'den küçüktür.
Finger jam is secure and the holes are smaller than 8 mm.
Yapıştırma ürünler 10 Bar 63 mm U-PVC borunun içine yapıştırmaya uygundur.
To be glued into a 63 mm PN-10 pipe.

LİNER Havuzlar / LINER Pools

**KARE
SQUARE**

Model
Sarı vida yuvalı
with brass insert

Debi
m³/saat

63mm UPVC PN10
Yapıştırma / Solvent

Mafsallı / Hinged
63mm PN10

2"
Dişli / Threaded

İç - Inside 50 mm
Yapıştırma / Solvent

Yapıştırma / Solvent

İç - Inside 50mm
Yapıştırma / Solvent

Kod / Code

Kod / Code

Kod / Code

**Kürel Yandan
Besleme Nozulu**

Ø17,5 mm
Emniyet kafesli
Safety cage

2,2

NOZK-401
17,04 €

NOZK-501
17,04 €

NOZK-601
17,04 €

**Wall Inlet with
Pivoting Ball**

Ø22,8 mm
Emniyet kafesli
Safety cage

4,5

NOZK-402
17,04 €

NOZK-502
17,04 €

NOZK-602
17,04 €

Ø27,0 mm
Emniyet kafesli
Safety cage

7

NOZK-403
17,04 €

NOZK-503
17,04 €

NOZK-603
17,04 €

Ø20 mm Kafesiz
Full Bore

4,5

NOZK-404
17,04 €

NOZK-504
17,04 €

NOZK-604
17,04 €

**Debi Ayarlı
Tabandan Besleme Nozulu**
Adjustable Floor Inlet

0-4,5

NOZK-405
17,89 €

NOZK-505
17,89 €

NOZK-605
17,89 €

NOZK-405D
17,89 €

NOZK-505D
17,89 €

NOZK-605D
17,89 €

**Yandan Çıkışlı
Tabandan Besleme Nozulu**
Output Side Floor Inlet

4,5

NOZK-406
17,04 €

NOZK-506
17,04 €

NOZK-606
17,04 €

Kafesli Besleme ve Emme Nozulu
*Floor Inlet and Suction
with Safety Cage*

NOZK-407
17,04 €

NOZK-507
17,04 €

NOZK-607
17,04 €

**Besleme - Inlet (10 m³/saat)
Emiş - Suction (1,25 m³/saat)**

NOZK-407D
17,04 €

NOZK-507D
17,04 €

NOZK-607D
17,04 €

Vakum Nozulu
Suction Inlet

7

NOZK-408
17,04 €

NOZK-508
17,04 €

NOZK-608
17,04 €

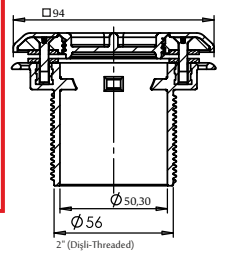
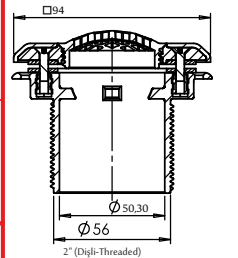
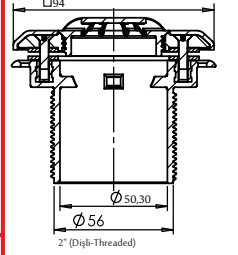
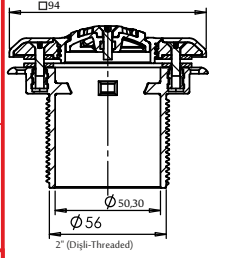
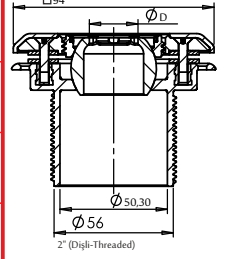

Nozullar orjinal ABS malzemeden üretilmiştir. UV ve antioksidant katkı, uzun ömürlüdür.
Nozzles are produced from original ABS material reinforced with UV and antioxidant.
Kürel (Emniyet kafesli) ve tabandan besleme nozullarımız EN 13451-3'e uygundur.
Wall inlet with pivoting ball and floor inlets with safety cage are suitable to EN 13451-3.
Parmak sıkışma emniyetli olup delikler 8 mm'den küçüktür.
Finger jam is secure and the holes are smaller than 8 mm.
Yapıştırma ürünler 10 Bar 63 mm U-PVC borunun içine yapıştırmaya uygundur.
To be glued into a 63 mm PN-10 pipe.

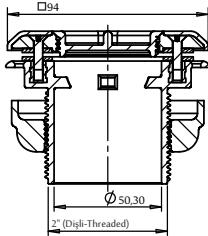
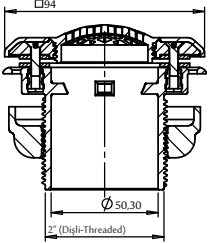
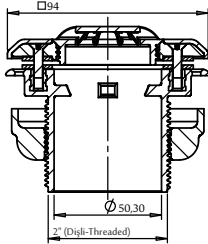
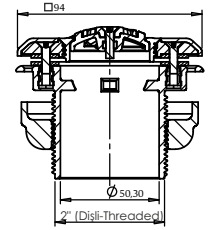
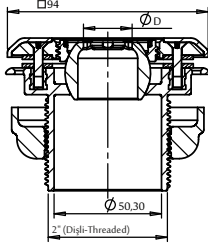

PANEL Havuzlar / PANEL Pools

Model	Debi m³/saat	2" Dişli / Threaded		Fiyat Price €
		İç - Inside 50mm Yapıştırma / Solvent	Kod / Code	
Kürelü Yandan Besleme Nozulu <i>Wall Inlet Nozzle Pivoting Ball</i>	Ø17,5 mm Küre Emniyet kafesli Safety cage	2,2	NOZK-701	22,01 €
	Ø22,8 mm Küre Emniyet kafesli Safety cage	4,5	NOZK-702	22,01 €
	Ø27,0 mm Küre Emniyet kafesli Safety cage	7	NOZK-703	22,01 €
	Ø20 mm Kafesiz Full Bore	4,5	NOZK-704	22,01 €
Debi Ayarlı Tabandan Besleme Nozulu <i>Adjustable Floor Inlet</i>		0-4,5	NOZK-705	22,86 €
			NOZK-705D	22,86 €
Yandan Çıkışlı Tabandan Besleme Nozulu <i>Floor Inlet Side Output</i>	4,5	NOZK-706	22,01 €	
Kafesli Besleme ve Emme Nozulu <i>Floor Inlet and Suction with Safety Cage</i>	Besleme - Inlet (10 m³/saat) Emiş - Suction (1,25 m³/saat)		NOZK-707	22,01 €
			NOZK-707D	22,01 €
Vakum Nozulu <i>Suction Inlet</i>	7	NOZK-708	22,01 €	

**KARE
SQUARE**



Nozullar orjinal ABS malzemeden üretilmiştir.

Nozzles were produced from original ABS material.

Kürelü (Emniyet kafesli) ve tabandan besleme nozullarımız EN 13451-3'e uygundur.

It is suitable for EN 13451-3 with globe (safety cage) and bottom nozzle.

Parmak sıkışma emniyetli olup delikler 8 mm'den küçüktür.

Finger jam is secure and the holes are 8 mm smaller.

POLYESTER Havuzlar / *POLYESTER Pools*

**KARE
SQUARE**



Model	Debi m ³ /saat	2" Dişli / Threaded		Fiyat Price €
		İç - Inside 50mm Yapıştırma / Solvent	Kod / Code	
Kürelü Yandan Besleme Nozulu <i>Wall Inlet Nozzle Pivoting Ball</i>	Ø17,5 mm Küre Emniyet kafesli <i>Safety cage</i>	2,2	NOZK-801	10,93 €
	Ø22,8 mm Küre Emniyet kafesli <i>Safety cage</i>	4,5	NOZK-802	10,93 €
	Ø27,0 mm Küre Emniyet kafesli <i>Safety cage</i>	7	NOZK-803	10,93 €
	Ø20 mm Kafesiz <i>Full Bore</i>	4,5	NOZK-804	10,93 €
Debi Ayarlı Tabandan Besleme Nozulu <i>Adjustable Floor Inlet</i>		0-4,5	NOZK-805	11,79 €
			NOZK-805D	11,79 €
Yandan Çıkışlı Tabandan Besleme Nozulu <i>Floor Inlet Side Output</i>		4,5	NOZK-806	10,93 €
Kafesli Besleme ve Emme Nozulu <i>Floor Inlet and Suction with Safety Cage</i>	Besleme - Inlet (10 m³/saat)		NOZK-807	10,93 €
	Emiş - Suction (1,25 m³/saat)		NOZK-807D	10,93 €
Vakum Nozulu <i>Suction Inlet</i>		7	NOZK-808	10,93 €

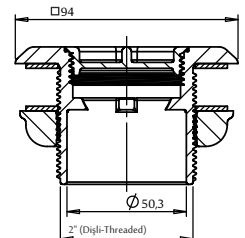
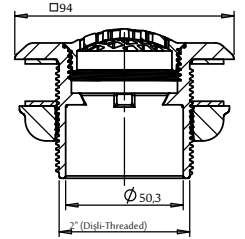
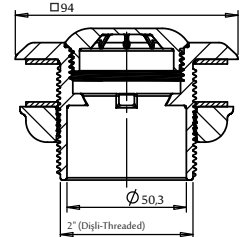
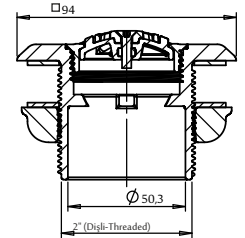
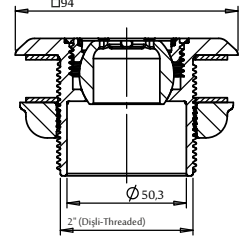

Nozullar orjinal ABS malzemeden üretilmiştir.

Nozzles were produced from original ABS material.

Kürelü (Emniyet kafesli) ve tabandan besleme nozullarımız EN 13451-3'e uygundur.

It is suitable for EN 13451-3 with globe (safety cage) and bottom nozzle.

Parmak sıkışma emniyetli olup delikler 8 mm'den küçüktür.

Finger jam is secure and the holes are 8 mm smaller.

BETON Havuzlar / CONCRETE Pools

Model	Debi m³/saat	63mm UPVC PN10 Yapıştırma / Solvent	Mafsallı / Hinged 63mm PN10	2" Dişli / Threaded	
		İç - Inside 50mm Yapıştırma / Solvent	Yapıştırma / Solvent	İç - Inside 50mm Yapıştırma / Solvent	
		Kod / Code	Kod / Code	Kod / Code	
Kürelü Yandan Besleme Nozulu <i>Wall Inlet with Pivoting Ball</i>	Ø17,5 mm Emniyet kafesli Safety cage	2,2	NOZK-101A 3,01 €	NOZK-201A 3,35 €	NOZK-301A 3,35 €
	Ø22,8 mm Emniyet kafesli Safety cage	4,5	NOZK-102A 3,01 €	NOZK-202A 3,35 €	NOZK-302A 3,35 €
	Ø27,0 mm Emniyet kafesli Safety cage	7	NOZK-103A 3,01 €	NOZK-203A 3,35 €	NOZK-303A 3,35 €
	Ø20 mm Kafesiz Full Bore	4,5	NOZK-104A 3,01 €	NOZK-204A 3,35 €	NOZK-304A 3,35 €
Debi Ayarlı Tabandan Besleme Nozulu <i>Adjustable Floor Inlet</i>		0-4,5	NOZK-105A 3,75 €	NOZK-205A 4,09 €	NOZK-305A 4,09 €
			NOZK-105DA 3,75 €	NOZK-205DA 4,09 €	NOZK-305DA 4,09 €
Yandan Çıkışlı Tabandan Besleme Nozulu <i>Output Side Floor Inlet</i>		4,5	NOZK-106A 3,01 €	NOZK-206A 3,35 €	NOZK-306A 3,35 €
Kafesli Besleme ve Emme Nozulu <i>Floor Inlet and Suction with Safety Cage</i>			NOZK-107A 3,01 €	NOZK-207A 3,35 €	NOZK-307A 3,35 €
	Besleme - Inlet (10 m³/saat) Emiş - Suction (1,25 m³/saat)		NOZK-107DA 3,01 €	NOZK-207DA 3,35 €	NOZK-307DA 3,35 €
Vakum Nozulu <i>Suction Inlet</i>		7	NOZK-108A 3,01 €	NOZK-208A 3,35 €	NOZK-308A 3,35 €

KARE ANTRASİT SQUARE ANTHRACITE

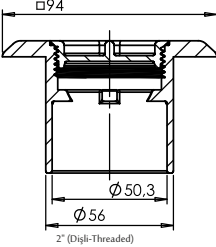
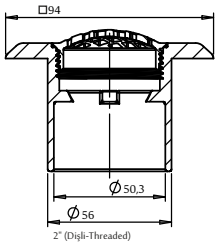
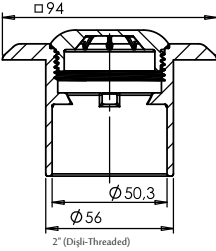
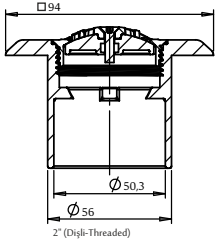
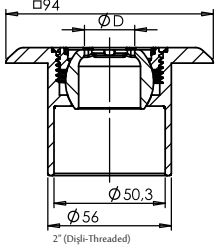

Nozullar orjinal ABS malzemeden üretilmiştir. UV ve antioksidant katkı, uzun ömürlüdür.
Nozzles are produced from original ABS material reinforced with UV and antioxidant.
Kürelü (Emniyet kafesli) ve tabandan besleme nozullarımız EN 13451-3'e uygundur.
Wall inlet with pivoting ball and floor inlets with safety cage are suitable to EN 13451-3.
Parmak sıkışma emniyetli olup delikler 8 mm'den küçüktür.
Finger jam is secure and the holes are smaller than 8 mm.
Yapıştırma ürünler 10 Bar 63 mm U-PVC borunun içine yapıştırmaya uygundur.
To be glued into a 63 mm PN-10 pipe.

LİNER Havuzlar / LINER Pools

KARE
ANTRASİT
SQUARE
ANTHRACITE

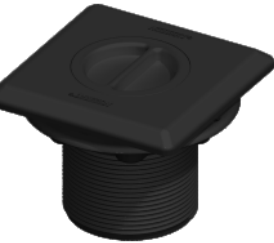
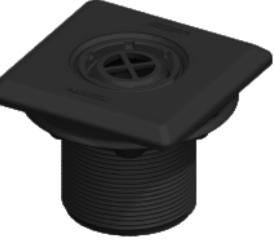

LİNER Havuzlar / LINER Pools					
Model	Debi m³/saat	63mm UPVC PN10 Yapıştırma / Solvent	Mafsallı / Hinged 63mm PN10	2" Dişli / Threaded	
		İç - Inside 50mm Yapıştırma / Solvent	Yapıştırma / Solvent	İç - Inside 50mm Yapıştırma / Solvent	
		Kod / Code	Kod / Code	Kod / Code	
Kürelü Yandan Besleme Nozulu <i>Wall Inlet with Pivoting Ball</i>	Ø17,5 mm Emniyet kafesli Safety cage	2,2	NOZK-401A 17,04 €	NOZK-501A 17,04 €	NOZK-601A 17,04 €
	Ø22,8 mm Emniyet kafesli Safety cage	4,5	NOZK-402A 17,04 €	NOZK-502A 17,04 €	NOZK-602A 17,04 €
	Ø27,0 mm Emniyet kafesli Safety cage	7	NOZK-403A 17,04 €	NOZK-503A 17,04 €	NOZK-603A 17,04 €
	Ø20 mm Kafesiz Full Bore	4,5	NOZK-404A 17,04 €	NOZK-504A 17,04 €	NOZK-604A 17,04 €
Debi Ayarlı Tabandan Besleme Nozulu <i>Adjustable Floor Inlet</i>		0-4,5	NOZK-405A 17,89 €	NOZK-505A 17,89 €	NOZK-605A 17,89 €
			NOZK-405DA 17,89 €	NOZK-505DA 17,89 €	NOZK-605DA 17,89 €
Yandan Çıkışlı Tabandan Besleme Nozulu <i>Output Side Floor Inlet</i>		4,5	NOZK-406A 17,04 €	NOZK-506A 17,04 €	NOZK-606A 17,04 €
Kafesli Besleme ve Emme Nozulu <i>Floor Inlet and Suction with Safety Cage</i>			NOZK-407A 17,04 €	NOZK-507A 17,04 €	NOZK-607A 17,04 €
	Besleme - Inlet (10 m³/saat) Emiş - Suction (1,25 m³/saat)		NOZK-407DA 17,04 €	NOZK-507DA 17,04 €	NOZK-607DA 17,04 €
Vakum Nozulu <i>Suction Inlet</i>		7	NOZK-408A 17,04 €	NOZK-508A 17,04 €	NOZK-608A 17,04 €

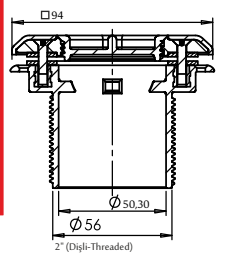
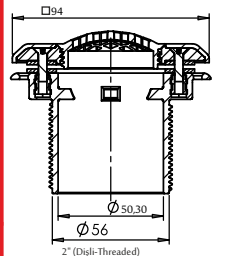
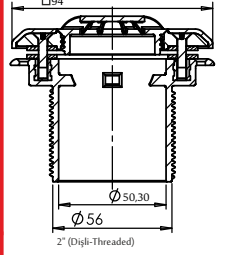
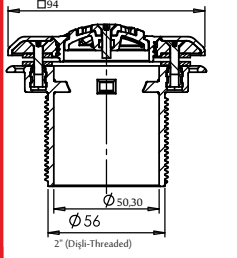
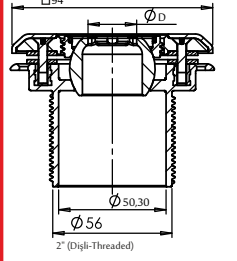

Nozullar orjinal ABS malzemeden üretilmiştir. UV ve antioksidant katkı, uzun ömürlüdür.

Nozzles are produced from original ABS material reinforced with UV and antioxidant.

Kürelü (Emniyet kafesli) ve tabandan besleme nozullarımız EN 13451-3'e uygundur.

Wall inlet with pivoting ball and floor inlets with safety cage are suitable to EN 13451-3.

Parmak sıkışma emniyetli olup delikler 8 mm'den küçüktür.

Finger jam is secure and the holes are smaller than 8 mm.

Yapıştırma ürünler 10 Bar 63 mm U-PVC borunun içine yapıştırmaya uygundur.

To be glued into a 63 mm PN-10 pipe.

PANEL Havuzlar / PANEL Pools

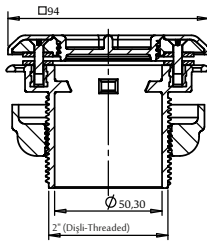
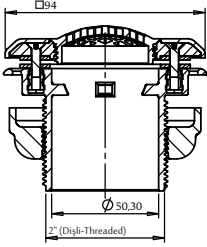
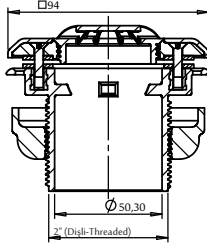
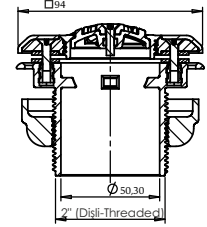
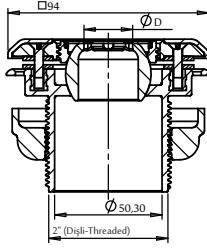

Model	Debi m³/saat	2" Dişli / Threaded		Fiyat Price €
		İç - Inside 50mm Yapıştırma / Solvent	Kod / Code	
Kürelü Yandan Besleme Nozulu <i>Wall Inlet Nozzle Pivoting Ball</i>	Ø17,5 mm Küre Emniyet kafesli Safety cage	2,2	NOZK-701A	22,01 €
	Ø22,8 mm Küre Emniyet kafesli Safety cage	4,5	NOZK-702A	22,01 €
	Ø27,0 mm Küre Emniyet kafesli Safety cage	7	NOZK-703A	22,01 €
	Ø20 mm Kafesiz Full Bore	4,5	NOZK-704A	22,01 €
Debi Ayarlı Tabandan Besleme Nozulu <i>Adjustable Floor Inlet</i>		0-4,5	NOZK-705A	22,86 €
			NOZK-705DA	22,86 €
Yandan Çıkışlı Tabandan Besleme Nozulu <i>Floor Inlet Side Output</i>		4,5	NOZK-706A	22,01 €
Kafesli Besleme ve Emme Nozulu <i>Floor Inlet and Suction with Safety Cage</i>			NOZK-707A	22,01 €
	Besleme - Inlet (10 m³/saat) Emiş - Suction (1,25 m³/saat)		NOZK-707DA	22,01 €
Vakum Nozulu <i>Suction Inlet</i>		7	NOZK-708A	22,01 €

KARE ANTRASİT SQUARE ANTHRACITE

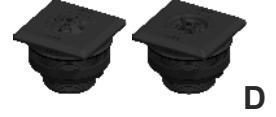

Nozullar orjinal ABS malzemeden üretilmiştir.

Nozzles were produced from original ABS material.

Kürelü (Emniyet kafesli) ve tabandan besleme nozullarımız EN 13451-3'e uygundur.

It is suitable for EN 13451-3 with globe (safety cage) and bottom nozzle.

Parmak sıkışma emniyetli olup delikler 8 mm'den küçüktür.

Finger jam is secure and the holes are 8 mm smaller.

POLYESTER Havuzlar / POLYESTER Pools

Model	Debi m ³ /saat	2" Dişli / Threaded	Fiyat Price €	
		İç - Inside 50mm Yapıştırma / Solvent		
		Kod / Code		
Kürel Yandan Besleme Nozulu <i>Wall Inlet Nozzle Pivoting Ball</i>	Ø17,5 mm Küre Emniyet kafesli <i>Safety cage</i>	2,2	NOZK-801A	10,93 €
	Ø22,8 mm Küre Emniyet kafesli <i>Safety cage</i>	4,5	NOZK-802A	10,93 €
	Ø27,0 mm Küre Emniyet kafesli <i>Safety cage</i>	7	NOZK-803A	10,93 €
	Ø20 mm Kafessiz <i>Full Bore</i>	4,5	NOZK-804A	10,93 €
Debi Ayarlı Tabandan Besleme Nozulu <i>Adjustable Floor Inlet</i>		0-4,5	NOZK-805A	11,79 €
			NOZK-805DA	11,79 €
Yandan Çıkışlı Tabandan Besleme Nozulu <i>Floor Inlet Side Output</i>		4,5	NOZK-806A	10,93 €
Kafesli Besleme ve Emme Nozulu <i>Floor Inlet and Suction with Safety Cage</i>			NOZK-807A	10,93 €
	Besleme - Inlet (10 m³/saat) Emiş - Suction (1,25 m³/saat)		NOZK-807DA	10,93 €
Vakum Nozulu <i>Suction Inlet</i>		7	NOZK-808A	10,93 €

KARE ANTRASİT SQUARE ANTHRACITE

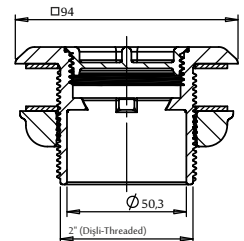
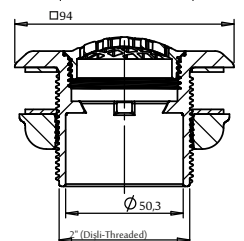
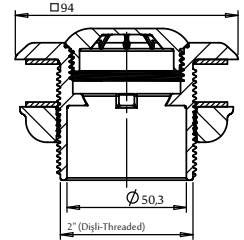
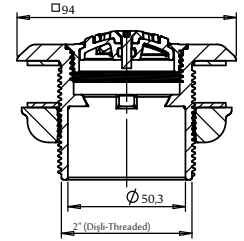
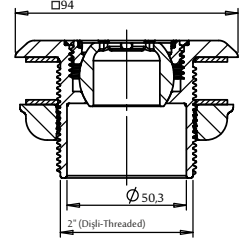
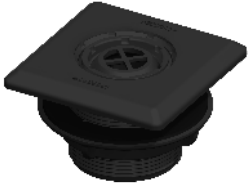

Nozullar orjinal ABS malzemeden üretilmiştir.

Nozzles were produced from original ABS material.

Kürel (Emniyet kafesli) ve tabandan besleme nozullarımız EN 13451-3'e uygundur.

It is suitable for EN 13451-3 with globe (safety cage) and bottom nozzle.

Parmak sıkışma emniyetli olup delikler 8 mm'den küçüktür.

Finger jam is secure and the holes are 8 mm smaller.

BETON Havuzlar / CONCRETE Pools

Model	Debi m³/saat	63mm UPVC PN10 Yapıştırma / Solvent	Mafsallı / Hinged 63mm PN10	2" Dişli / Threaded	
		İç - Inside 50mm Yapıştırma / Solvent	Yapıştırma / Solvent	İç - Inside 50mm Yapıştırma / Solvent	
		Kod / Code	Kod / Code	Kod / Code	
Kürel Yandan Besleme Nozulu (Krom)	Ø17,5 mm Emniyet kafesli Safety cage	2,2	NOZ-101K 24,81 €	NOZ-201K 25,15 €	NOZ-301K 25,15 €
	Ø22,8 mm Emniyet kafesli Safety cage	4,5	NOZ-102K 24,81 €	NOZ-202K 25,15 €	NOZ-302K 25,15 €
Wall Inlet with Pivoting Ball (Chrome)	Ø27,0 mm Emniyet kafesli Safety cage	7	NOZ-103K 24,81 €	NOZ-203K 25,15 €	NOZ-303K 25,15 €
	Ø20 mm Mafessiz Full Bore	4,5	NOZ-104K 24,81 €	NOZ-204K 25,15 €	NOZ-304K 25,15 €
Debi Ayarlı Tabandan Besleme Nozulu (Krom)		0-4,5	NOZ-105K 25,90 €	NOZ-205K 25,90 €	NOZ-305K 25,90 €
	Adjustable Floor Inlet (Chrome)		NOZ-105DK 25,90 €	NOZ-205DK 25,90 €	NOZ-305DK 25,90 €
Yandan Çıkışlı Tabandan Besleme Nozulu (Krom)		4,5	NOZ-106K 24,81 €	NOZ-206K 25,15 €	NOZ-306K 25,15 €
	Output Side Floor Inlet (Chrome)				
Kafesli Besleme ve Emme Nozulu (Krom)			NOZ-107K 24,81 €	NOZ-207K 25,15 €	NOZ-307K 25,15 €
	Floor Inlet and Suction with Safety Cage (Chrome)		NOZ-107DK 24,81 €	NOZ-207DK 25,15 €	NOZ-307DK 25,15 €
Besleme - Inlet (10 m³/saat) Emiş - Suction (1,25 m³/saat)					
Vakum Nozulu (Krom)		7	NOZ-108K 24,81 €	NOZ-208K 25,15 €	NOZ-308K 25,15 €
	Suction Inlet (Chrome)				

**KROM
CHROME**

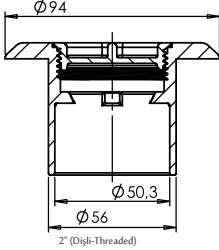
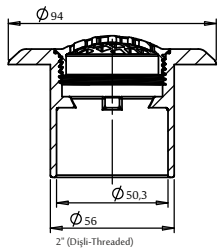
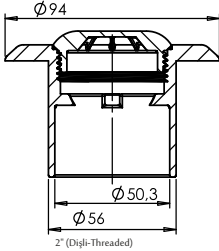
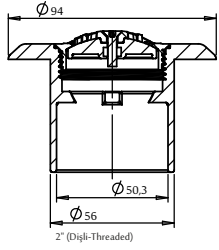
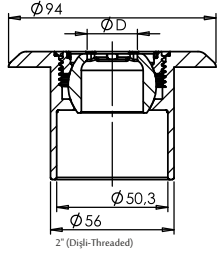

Nozullar orjinal ABS malzemeden üretilmiştir. UV ve antioksidant katkılı, uzun ömürlüdür.
Nozzles are produced from original ABS material reinforced with UV and antioxidant.
Kürel (Emniyet kafesli) ve tabandan besleme nozullarımız EN 13451-3'e uygundur.
Wall inlet with pivoting ball and floor inlets with safety cage are suitable to EN 13451-3.
Parmak sıkışma emniyetli olup delikler 8 mm'den küçüktür.
Finger jam is secure and the holes are smaller than 8 mm.
Yapıştırma ürünler 10 Bar 63 mm U-PVC borunun içine yapıştırmaya uygundur.
To be glued into a 63 mm PN-10 pipe.

LİNER Havuzlar / LINER Pools

Model		Debi m ³ /saat	63mm UPVC PN10 Yapıştırma / Solvent	Mafsallı / Hinged 63mm Pn10	2" Dişli / Threaded
Sarı vida yuvalı with brass insert			İç - Inside 50mm Yapıştırma / Solvent	Yapıştırma / Solvent	İç - Inside 50mm Yapıştırma / Solvent
			Kod / Code	Kod / Code	Kod / Code
Kürel Yandan Besleme Nozulu (Krom) <i>Wall Inlet with Pivoting Ball (Chrome)</i>	Ø17,5 mm Emniyet kafesli Safety cage	2,2	NOZ-401K 38,85 €	NOZ-501K 38,85 €	NOZ-601K 38,85 €
	Ø22,8 mm Emniyet kafesli Safety cage	4,5	NOZ-402K 38,85 €	NOZ-502K 38,85 €	NOZ-602K 38,85 €
	Ø27,0 mm Emniyet kafesli Safety cage	7	NOZ-403K 38,85 €	NOZ-503K 38,85 €	NOZ-603K 38,85 €
	Ø20 mm Kafesiz Full Bore	4,5	NOZ-404K 38,85 €	NOZ-504K 38,85 €	NOZ-604K 38,85 €
Debi Ayarlı Tabandan Besleme Nozulu (Krom) <i>Adjustable Floor Inlet (Chrome)</i>		0-4,5	NOZ-405K 39,70 €	NOZ-505K 39,70 €	NOZ-605K 39,70 €
			NOZ-405DK 39,70 €	NOZ-505DK 39,70 €	NOZ-605DK 39,70 €
Yandan Çıkışlı Tabandan Besleme Nozulu (Krom) <i>Output Side Floor Inlet (Chrome)</i>		4,5	NOZ-406K 38,85 €	NOZ-506K 38,85 €	NOZ-606K 38,85 €
Kafesli Besleme ve Emme Nozulu <i>Floor Inlet and Suction with Safety Cage</i>			NOZ-407K 38,85 €	NOZ-507K 38,85 €	NOZ-607K 38,85 €
Besleme - Inlet (10 m³/saat) Emiş - Suction (1,25 m³/saat)			NOZ-407DK 38,85 €	NOZ-507DK 38,85 €	NOZ-607DK 38,85 €
Vakum Nozulu <i>Suction Inlet</i>		7	NOZ-408K 38,85 €	NOZ-508K 38,85 €	NOZ-608K 38,85 €

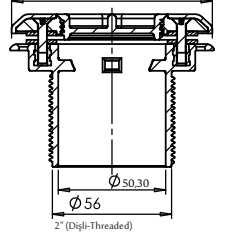
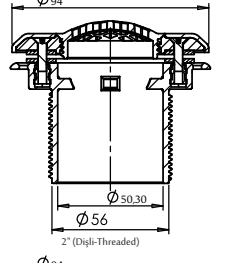
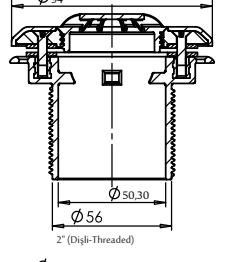
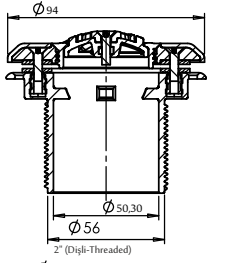
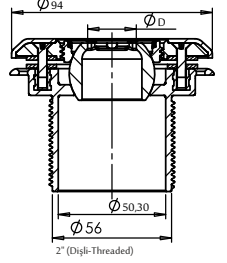

Nozullar orjinal ABS malzemeden üretilmiştir.

Nozzles were produced from original ABS material.

Kürel (Emniyet kafesli) ve tabandan besleme nozullarımız EN 13451-3'e uygundur.

It is suitable for EN 13451-3 with globe (safety cage) and bottom nozzle.

Parmak sıkışma emniyetli olup delikler 8 mm'den küçüktür.

Finger jam is secure and the holes are 8 mm smaller.

Yapıştırma ürünler 10 Bar 63 mm U-PVC borunun içine yapıştırmaya uygundur.

To be glued into a 63 mm PN-10 pipe.

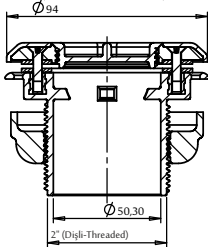
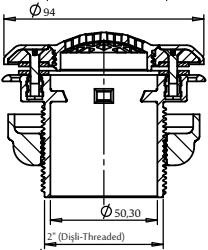
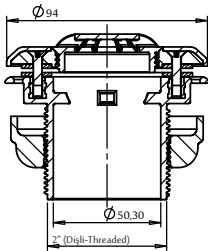
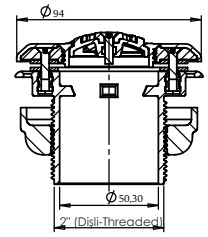
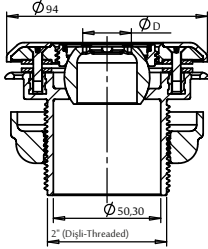

PANEL Havuzlar / PANEL Pools				
Model	Debi m ³ /saat	2" Dişli / Threaded		Fiyat Price €
		İç - Inside 50mm Yapıştırma / Solvent	Kod / Code	
Kürel Yandan Besleme Nozulu Wall Inlet Nozzle Pivoting Ball	Ø17,5 mm Küre Emniyet kafesli Safety cage	2,2	NOZ-701K	43,79 €
	Ø22,8 mm Küre Emniyet kafesli Safety cage	4,5	NOZ-702K	43,79 €
	Ø27,0 mm Küre Emniyet kafesli Safety cage	7	NOZ-703K	43,79 €
	Ø20 mm Kafessiz Full Bore	4,5	NOZ-704K	43,79 €
Debi Ayarlı Tabandan Besleme Nozulu Adjustable Floor Inlet		0-4,5	NOZ-705K	44,64 €
			NOZ-705DK	44,64 €
Yandan Çıkışlı Tabandan Besleme Nozulu Floor Inlet Side Output		4,5	NOZ-706K	43,79 €
Kafesli Besleme ve Emme Nozulu Floor Inlet and Suction with Safety Cage	Besleme - Inlet (10 m ³ /saat) Emiş - Suction (1,25 m ³ /saat)		NOZ-707K	43,79 €
			NOZ-707DK	43,79 €
Vakum Nozulu Suction Inlet		7	NOZ-708K	43,79 €

KROM
CHROME



D



D



Nozullar orjinal ABS malzemeden üretilmiştir.

Nozzles were produced from original ABS material.

Kürel (Emniyet kafesli) ve tabandan besleme nozullarımız EN 13451-3'e uygundur.

It is suitable for EN 13451-3 with globe (safety cage) and bottom nozzle.

Parmak sıkışma emniyetli olup delikler 8 mm'den küçüktür.

Finger jam is secure and the holes are 8 mm smaller.

**KROM
CHROME**

NOZ-801K



NOZ-802K NOZ-803K NOZ-804K

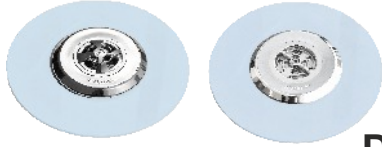

D



D



POLYESTER Havuzlar / POLYESTER Pools

Model		Debi m ³ /saat	2" Dişli (Threaded)	Fiyat Price €
Sarı vida yuvalı with brass insert			İç - Inside 50 mm Yapıştırma (Solvent)	
			Kod / Code	
Kürel Yandan Besleme Nozulu Wall Inlet Nozzle Pivoting Ball	Ø17,5 mm Küre Emniyet kafesli Safety cage	2,2	NOZ-801K	32,72 €
	Ø22,8 mm Küre Emniyet kafesli Safety cage	4,5	NOZ-802K	32,72 €
	Ø27,0 mm Küre Emniyet kafesli Safety cage	7	NOZ-803K	32,72 €
	Ø20 mm Kafesiz Full Bore	4,5	NOZ-804K	32,72 €
Debi Ayarlı Tabandan Besleme Nozulu Adjustable Floor Inlet		0-4,5	NOZ-805K	33,57 €
			NOZ-805DK	33,57 €
Yandan Çıkışlı Tabandan Besleme Nozulu Floor Inlet Side Output		4,5	NOZ-806K	32,72 €
Kafesli Besleme ve Emme Nozulu Floor Inlet and Suction with Safety Cage			NOZ-807K	32,72 €
Besleme - Inlet (10 m ³ /saat) Emiş - Suction (1,25 m ³ /saat)			NOZ-807DK	32,72 €
Vakum Nozulu Suction Inlet		7	NOZ-808K	32,72 €

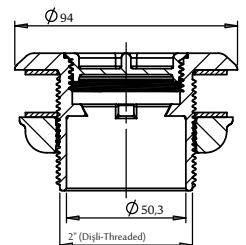
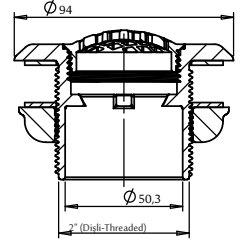
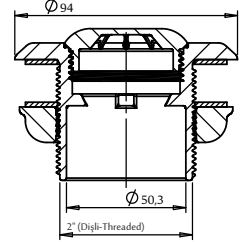
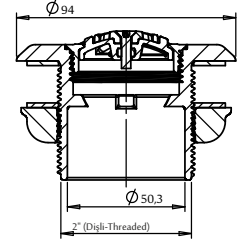
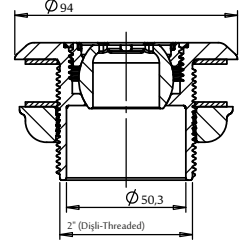

Nozullar orjinal ABS malzemeden üretilmiştir.

Nozzles were produced from original ABS material.

Kürel (Emniyet kafesli) ve tabandan besleme nozullarımız EN 13451-3'e uygundur.

It is suitable for EN 13451-3 with globe (safety cage) and bottom nozzle.

Parmak sıkışma emniyetli olup delikler 8 mm'den küçüktür.

Finger jam is secure and the holes are 8 mm smaller.

316 PASLANMAZ ÇELİK MUHAFAZALI NOZULLAR AISI-316 STAINLESS STEEL CASING NOZZLES

Yönlendirilebilir duvar besleme (Beton)
Orientable wall inlet (Concrete)

Cod.	€	Kg	m ³	U
87198022	84,35	0,42	0,0019	x2

Çıkış / Output ø 20 mm Dış bağlantı / male connection 2"
İç bağlantı / female connection 1 1/2"



Beton / Concrete

Yönlendirilebilir besleme nozulu (Liner ve Polyester)
Orientable wall inlet (Liner and Polyester)

Cod.	€	Kg	m ³	U
87198042	170,68	1,74	0,0036	x2

Çıkış / Output ø 20 mm Dış bağlantı / male connection 2"
İç bağlantı / female connection 1 1/2"



Liner & Polyester

Vakum Nozulu (Liner ve Polyester)
Vacuum inlet with cover (Liner and Polyester)

Cod.	€	Kg	m ³	U
87198052	164,44	0,90	0,0015	x1

Dış bağlantı / male connection 2"
İç bağlantı / female connection 1 1/2"



TEK GEÇME SAVAK IZGARALARI
OVERFLOW GRATINGS WITH ONE CONNECTION PART

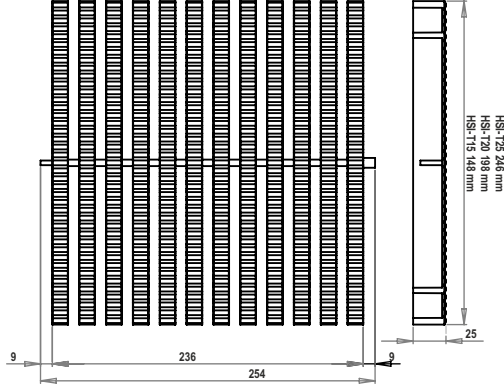
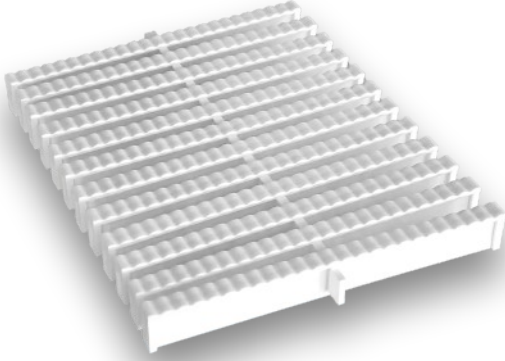

MALZEME CİNSİ DESCRIPTION	KOD NO: CODE NO:	FİYATI/METRE (€) PRICE/METER	AMBALAJ PACKAGE
15 cm. Tek geçme havuz ızgarası 15 cm. Overflow grating with one connection part	HSI-T15	12,78	10 METRE 10 METERS
20 cm. Tek geçme havuz ızgarası 20 cm. Overflow grating with one connection part	HSI-T20	14,20	10 METRE 10 METERS
25 cm. Tek geçme havuz ızgarası 25 cm. Overflow grating with one connection part	HSI-T25	18,46	10 METRE 10 METERS

ÇİFT GEÇME SAVAK IZGARALARI
OVERFLOW GRATINGS WITH TWO CONNECTION PARTS

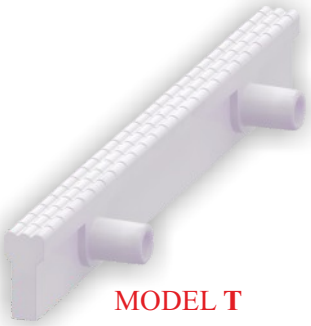
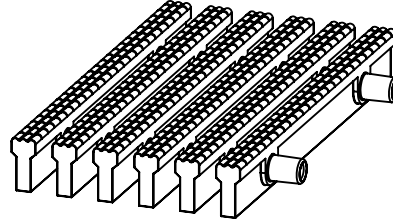

MODEL T

MALZEME CİNSİ DESCRIPTION	KOD NO: CODE NO:	FİYATI/METRE (€) PRICE/METER	AMBALAJ PACKAGE
20 cm. Çift geçme havuz ızgarası 20 cm. Overflow grating with two connection parts	HSI-C20	21,30	10 METRE 10 METERS
25 cm. Çift geçme havuz ızgarası 25 cm. Overflow grating with two connection parts	HSI-C25	21,30	10 METRE 10 METERS

MODEL I

MALZEME CİNSİ DESCRIPTION	KOD NO: CODE NO:	FİYATI/METRE (€) PRICE/METER	AMBALAJ PACKAGE
20 cm. Çift geçme havuz ızgarası 20 cm. Overflow grating with two connection parts	HSI-C21	12,07	10 METRE 10 METERS
25 cm. Çift geçme havuz ızgarası 25 cm. Overflow grating with two connection parts	HSI-C26	15,62	10 METRE 10 METERS
30 cm. Çift geçme havuz ızgarası 30 cm. Overflow grating with two connection parts	HSI-C31	26,27	10 METRE 10 METERS

SAVAK KENAR PROFİLİ EDGE PROFIL

MALZEME CİNSİ DESCRIPTION	KOD NO: CODE NO:	FİYATI (€) PRICE	AMBALAJ PACKAGE
Savak kenar profili Edge profil	SKP-001	4,70 €/m	1 ADET 1 UNIT



HAVUZ KÖŞE PARÇALARI CORNER PARTS

MALZEME CİNSİ DESCRIPTION	KOD NO: CODE NO:	FİYATI/ADET (€) PRICE/UNIT	AMBALAJ PACKAGE
15 cm. Tek geçme köşe parçası 90° 15 cm. Corner part with one connection 90°	TGK-9015	15,62	1 ADET 1 UNIT
20 cm. Tek geçme köşe parçası 90° 20 cm. Corner part with one connection 90°	TGK-9020	17,04	1 ADET 1 UNIT
25 cm. Tek geçme köşe parçası 90° 25 cm. Corner part with one connection 90°	TGK-9025	21,30	1 ADET 1 UNIT

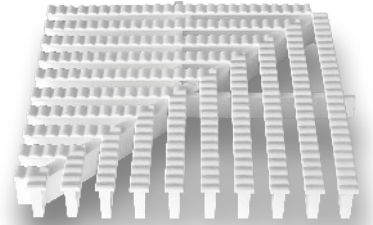

MALZEME CİNSİ DESCRIPTION	KOD NO: CODE NO:	FİYATI/ADET (€) PRICE/UNIT	AMBALAJ PACKAGE
15 cm. Çift geçme köşe parçası 45° 15 cm. Corner part with two connections 45°	CGK-4515	9,09	1 ADET 1 UNIT
20 cm. Çift geçme köşe parçası 45° 20 cm. Corner part with two connections 45°	CGK-4520	9,09	1 ADET 1 UNIT
25 cm. Çift geçme köşe parçası 45° 25 cm. Corner part with two connections 45°	CGK-4525	13,92	1 ADET 1 UNIT
30 cm. Çift geçme köşe parçası 45° 30 cm. Corner part with two connections 45°	CGK-4530	25,13	1 ADET 1 UNIT

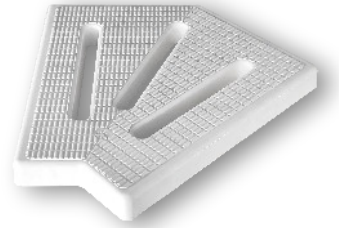

MALZEME CİNSİ DESCRIPTION	KOD NO: CODE NO:	FİYATI/ADET (€) PRICE/UNIT	AMBALAJ PACKAGE
15 cm. Çift geçme köşe parçası 90° 15 cm. Corner part with two connections 90°	CGK-9015	11,64	1 ADET 1 UNIT
20 cm. Çift geçme köşe parçası 90° 20 cm. Corner part with two connections 90°	CGK-9020	11,64	1 ADET 1 UNIT
25 cm. Çift geçme köşe parçası 90° 25 cm. Corner part with two connections 90°	CGK-9025	15,19	1 ADET 1 UNIT
30 cm. Çift geçme köşe parçası 90° 30 cm. Corner part with two connections 90°	CGK-9030	25,13	1 ADET 1 UNIT

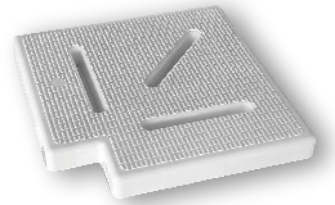

KARE DİP SÜZGEÇİ
SQUARE MAIN DRAIN



Beton / Concrete

MALZEME CİNSİ DESCRIPTION	KOD NO: CODE NO:	FİYAT (€) PRICE
Kare dip süzgeci 63 mm'lik yapıştırma Square main drain 63 mm bonding	DSK-063	20,45
Kare dip süzgeci 75 mm'lik yapıştırma Square main drain 75 mm bonding	DSK-075	20,45
Kare dip süzgeci 90 mm'lik yapıştırma Square main drain 90 mm bonding	DSK-090	20,45

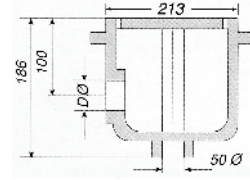

Liner & Polyester

MALZEME CİNSİ DESCRIPTION	KOD NO: CODE NO:	FİYAT (€) PRICE
Kare dip süzgeci 63 mm'lik yapıştırma (Liner) Square main drain 63 mm bonding (Liner)	DSK-064	42,03
Kare dip süzgeci 75 mm'lik yapıştırma (Liner) Square main drain 75 mm bonding (Liner)	DSK-076	42,03
Kare dip süzgeci 90 mm'lik yapıştırma (Liner) Square main drain 90 mm bonding (Liner)	DSK-091	42,03

YUVARLAK DİP SÜZGEÇİ
CIRCULAR BOTTOM GRID



Beton / Concrete

MALZEME CİNSİ DESCRIPTION	KOD NO: CODE NO:	FİYAT (€) PRICE
Yuvarlak dip süzgeci 50mm'lik yapıştırma Circular bottom grid 50mm bonding	DSY-050	19,88
Yuvarlak dip süzgeci 63mm'lik yapıştırma Circular bottom grid 63mm bonding	DSY-063	19,88



Liner & Polyester

MALZEME CİNSİ DESCRIPTION	KOD NO: CODE NO:	FİYAT (€) PRICE
Yuvarlak dip süzgeci 50mm'lik yapıştırma (Liner) Circular bottom grid 50mm bonding (Liner)	DSY-051	22,72
Yuvarlak dip süzgeci 63mm'lik yapıştırma (Liner) Circular bottom grid 63mm bonding (Liner)	DSY-064	22,72

KARE DİP IZGARASI
SQUARE DIP GRATING



Beton / Concrete

MALZEME CİNSİ DESCRIPTION	KOD NO: CODE NO:	FİYAT (€) PRICE
Kare dip ızgarası 25x25cm. Square dip grating 25x25cm	KDI-001	17,04

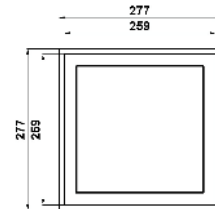

PASLANMAZ KARE DİP IZGARASI
SQUARE DIP GRATING INOX

AISI 316

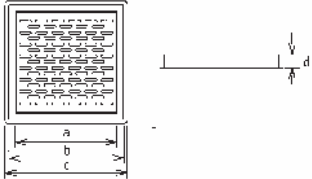

Cod.	€	a	b	c	d	Kg	m ³
87198012	260,29	210	253	270	30	1,229	0,003364
87198013	331,85	305	335	350	30	2,338	0,005995

Beton / Concrete**PASLANMAZ SÜZGEÇ (LİNER VE POLYESTER)**
MAIN DRAIN INOX (LİNER AND POLYESTER)

Paslanmaz süzgeç (Liner ve Polyester)
Main drain Inox (Liner and Polyester)

AISI 316

Cod.	€	Kg	m ³	U
87198014	207,32	1,65	0,0126	x1

İç bağlantı / female connection 2"

Liner & Polyester

PLASTİK SKİMMERLER
PLASTIC SKIMMERS

Beton
Concrete



MALZEME CİNSİ DESCRIPTION	KOD NO: CODE NO:	FİYAT (€) PRICE
2" Kare Kapaklı Skimmer 2" Square Frame Standard Skimmer	EKP-101	77,00

Ø63 mm yapıştırma soketli
Ø63 mm female solvent socket

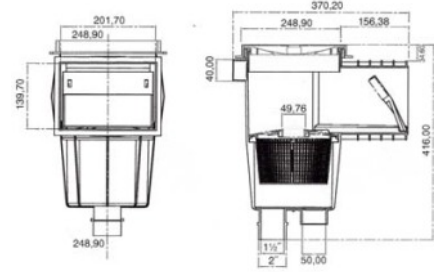

Liner ve Polyester
Liner and Polyester



MALZEME CİNSİ DESCRIPTION	KOD NO: CODE NO:	FİYAT (€) PRICE
2" Kare Kapaklı Skimmer (liner havuzlar için) 2" Square Frame Standard Skimmer (for liner pool)	EKP-102	134,20

Ø63 mm yapıştırma soketli
Ø63 mm female solvent socket

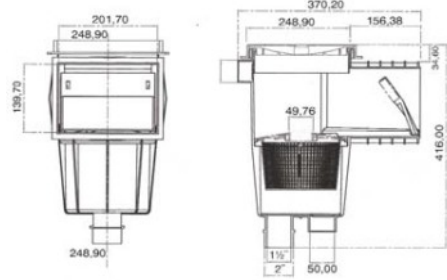

Beton
Concrete



MALZEME CİNSİ DESCRIPTION	KOD NO: CODE NO:	FİYAT (€) PRICE
2" Kare Kapaklı Geniş Ağızlı Skimmer 2" Square Frame Trapezium Mouth Skimmer	EKP-103	134,20

Ø63 mm yapıştırma soketli
Ø63 mm female solvent socket

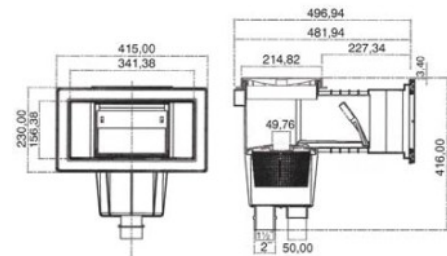

Liner ve Polyester
Liner and Polyester



MALZEME CİNSİ DESCRIPTION	KOD NO: CODE NO:	FİYAT (€) PRICE
2" Kare Kapaklı Geniş Ağızlı Skimmer (liner havuzlar için) 2" Square Frame Trapezium Mouth Skimmer (for liner pool)	EKP-104	210,90

Ø63 mm yapıştırma soketli
Ø63 mm female solvent socket

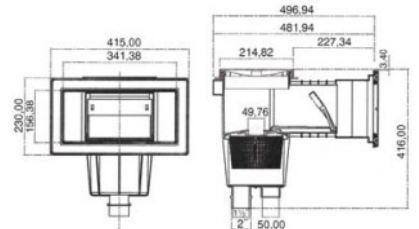

316 PASLANMAZ ÇELİK KAPAKLI SKİMMERLER
SKIMMERS WITH AISI-316 STAINLESS STEEL FRAME MOUTH**Beton**
Concrete**Standart ağızlı skimer (Beton)**
Skimmer standart mouth (Concrete)

Cod.	€	Kg	m ³	U
87192011	656,04	2,65	0,04	x1

**Konik ağızlı geniş skimer (Beton)**
Skimmer trapezium mouth (Concrete)

Cod.	€	Kg	m ³	U
87192013	962,76	6,20	0,108	x1

**Liner ve Polyester**
Liner and Polyester**Standart ağızlı skimer (Liner ve Polyester)**
Skimmer standart mouth (Liner and Polyester)

Cod.	€	Kg	m ³	U
87192010	661,15	2,75	0,04	x1

**Konik ağızlı geniş skimer (Liner ve Polyester)**
Skimmer trapezium mouth (Liner and polyester)

Cod.	€	Kg	m ³	U
87192012	984,06	6,30	0,108	x1

